

云浮市云安区石城镇上洞村委迳心岭地段地块六宗地红线图

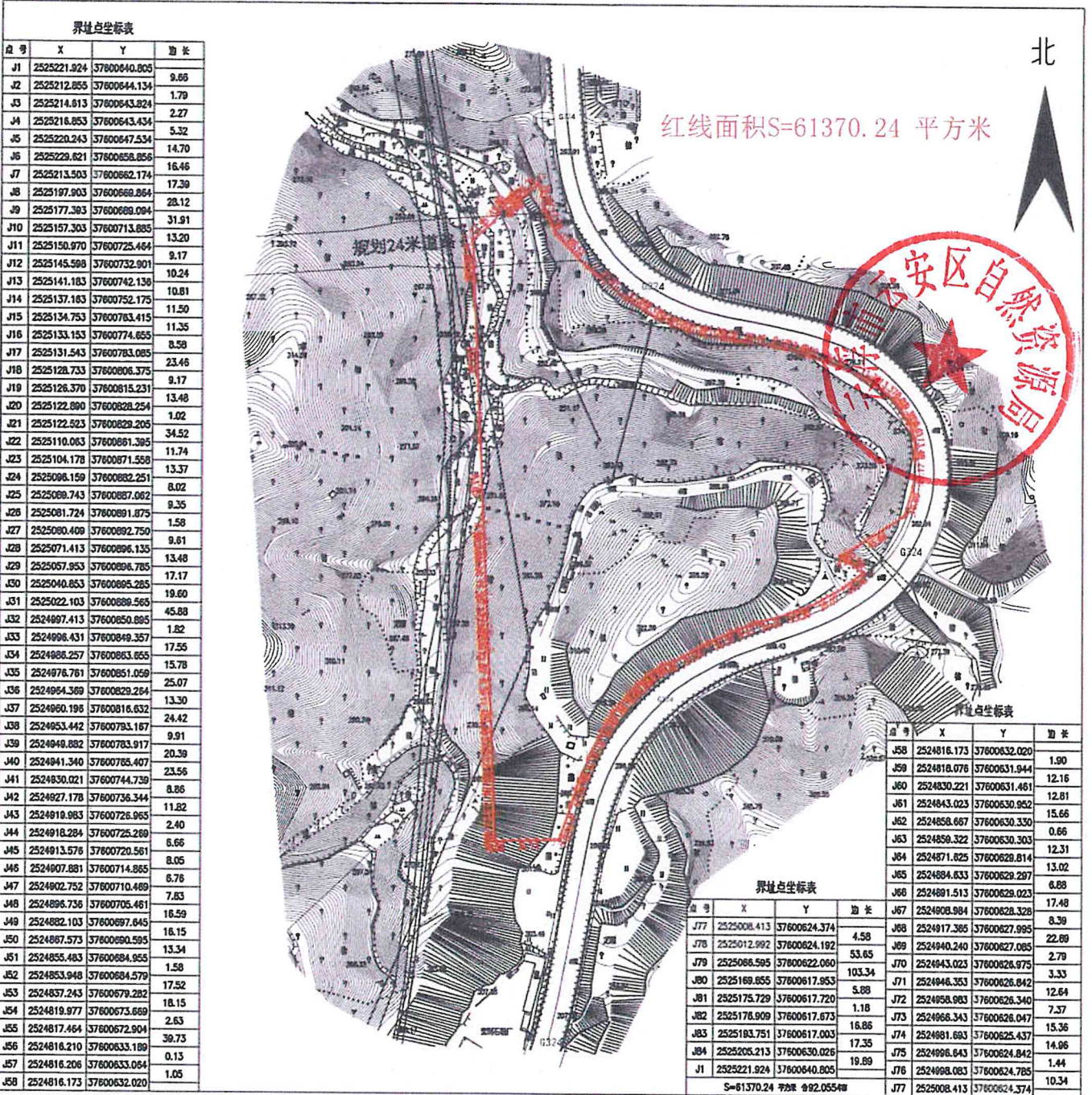

界址点坐标表

点号	X	Y	边长
J1	2525221.924	37600640.805	9.66
J2	2525212.655	37600644.134	1.79
J3	2525214.613	37600643.824	2.27
J4	2525216.653	37600643.434	5.32
J5	2525220.243	37600647.534	14.70
J6	2525229.621	37600658.856	16.46
J7	2525213.503	37600662.174	17.39
J8	2525197.903	37600669.894	28.12
J9	2525177.383	37600669.094	31.91
J10	2525157.303	37600713.885	13.20
J11	2525150.970	37600725.464	9.17
J12	2525145.598	37600732.901	10.24
J13	2525141.183	37600742.139	10.81
J14	2525137.163	37600752.175	11.59
J15	2525134.753	37600763.415	11.35
J16	2525133.153	37600774.655	8.58
J17	2525131.543	37600783.085	23.46
J18	2525128.733	37600806.375	9.17
J19	2525126.370	37600815.231	13.48
J20	2525122.890	37600828.254	1.02
J21	2525122.623	37600829.205	34.52
J22	2525110.063	37600861.395	11.74
J23	2525104.178	37600871.558	13.37
J24	2525098.159	37600882.251	8.02
J25	2525089.743	37600887.062	9.35
J26	2525081.724	37600891.875	1.58
J27	2525080.409	37600892.570	9.81
J28	2525071.413	37600896.135	13.48
J29	2525057.853	37600896.785	17.17
J30	2525040.853	37600895.285	19.60
J31	2525022.103	37600889.565	45.88
J32	2524997.413	37600850.895	1.82
J33	2524996.431	37600849.357	17.55
J34	2524988.257	37600863.655	15.78
J35	2524976.761	37600851.059	25.07
J36	2524964.369	37600829.254	13.30
J37	2524960.196	37600816.632	24.42
J38	2524953.442	37600783.167	9.91
J39	2524949.882	37600783.917	20.39
J40	2524941.340	37600765.407	23.56
J41	2524930.021	37600744.739	8.86
J42	2524927.178	37600736.344	11.82
J43	2524919.983	37600726.965	2.40
J44	2524918.284	37600725.289	6.66
J45	2524913.576	37600720.581	8.05
J46	2524907.881	37600714.855	6.78
J47	2524902.752	37600710.469	7.83
J48	2524896.736	37600705.461	16.59
J49	2524882.103	37600697.645	16.15
J50	2524867.573	37600690.595	13.34
J51	2524855.483	37600684.955	1.58
J52	2524853.948	37600684.579	17.52
J53	2524837.243	37600679.282	18.15
J54	2524819.977	37600673.669	2.63
J55	2524817.464	37600672.904	39.73
J56	2524816.210	37600633.189	0.13
J57	2524816.206	37600633.064	1.05
J58	2524816.173	37600632.020	1.90

红线面积S=61370.24 平方米



界址点坐标表

点号	X	Y	边长
J58	2524816.173	37600632.020	1.90
J59	2524816.076	37600631.944	12.16
J60	2524830.221	37600631.461	12.81
J61	2524843.023	37600630.952	15.66
J62	2524858.667	37600630.330	0.66
J63	2524859.322	37600630.303	12.31
J64	2524871.625	37600628.814	13.02
J65	2524884.633	37600629.297	6.68
J66	2524881.513	37600628.023	17.48
J67	2524903.994	37600628.328	8.39
J68	2524917.385	37600627.995	22.89
J69	2524940.240	37600627.065	2.79
J70	2524943.023	37600626.975	3.33
J71	2524946.353	37600626.842	12.64
J72	2524958.983	37600626.340	7.57
J73	2524968.343	37600626.047	15.36
J74	2524981.693	37600625.437	14.96
J75	2524998.643	37600624.842	1.44
J76	2524998.083	37600624.785	10.34
J77	2525008.413	37600624.374	4.58
J78	2525012.992	37600624.192	53.65
J79	2525066.595	37600622.060	103.34
J80	2525169.855	37600617.953	5.88
J81	2525175.729	37600617.720	1.18
J82	2525178.909	37600617.673	16.86
J83	2525183.751	37600617.003	17.35
J84	2525205.213	37600630.026	19.89
J1	2525221.924	37600640.805	9.66

云浮市中邦测绘服务有限公司

国家2000大地坐标系
1985国家高程基准,等高距为1米
2007年版图式
2023年11月数字化测制

1:3700

制图者: 李维灿

审核者: 周意

云浮市中邦测绘服务有限公司
出图专用章
资质等级 乙级 资质编号 44516087